

STRAIGHT PLUG CRIMP TYPE
CABLE 6/75 S - WITH BLACK CABLE BOOT

R142.085.480

Series : BNC 75-
COM

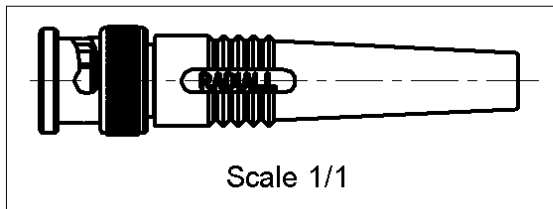
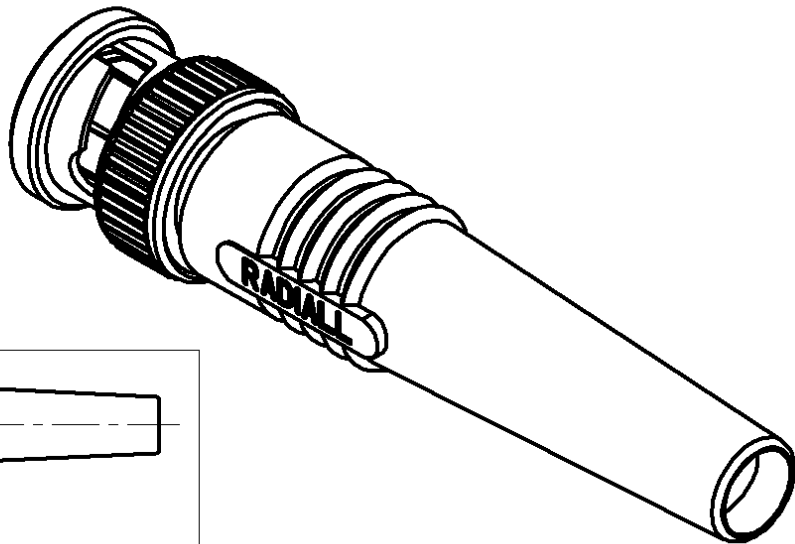
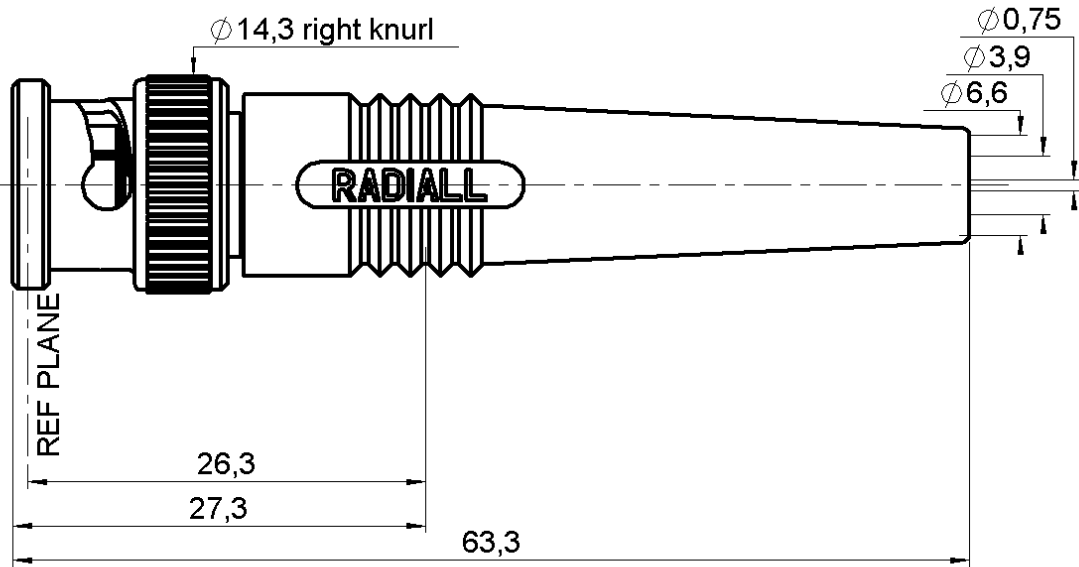

All dimensions are in mm.

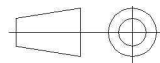

COMPONENTS	MATERIALS	PLATINGS (µm)
BODY	BRASS	NICKEL 2
CENTER CONTACT	BRASS	GOLD 0.2 OVER NICKEL 2
OUTER CONTACT	-	-
INSULATOR	POLYPROPYLENE	
GASKET	SILICONE RUBBER	
OTHERS PARTS	DIE-CAST	NICKEL 2 OVER COPPER 8
-	-	-
-	-	-

Issue : 0808 C

In the effort to improve our products, we reserve the right to make changes judged to be necessary.



STRAIGHT PLUG CRIMP TYPE

R142.085.480

CABLE 6/75 S - WITH BLACK CABLE BOOT

Series : **BNC 75-COM**

PACKAGING

Standard	Unit	Other
100	'W' option	Contact us

SPECIFICATION

ELECTRICAL CHARACTERISTICS

Impedance	75 Ω
Frequency	0-1.5 GHz
VSWR	NA + 0,0000 x F(GHz) Maxi
Insertion loss	NA √F(GHz) dB Maxi
RF leakage	- (NA - F(GHz)) dB mini
Voltage rating	500 Veff Maxi
Dielectric withstanding voltage	1500 Veff mini
Insulation resistance	5000 MΩ mini

CABLE ASSEMBLY

Stripping	a	b	c	d	e	f
mm	4,00	8,50	15,0	0,00	11,0	0,00

Assembly instruction :

Recommended cable(s)
KX 6A
RG 59

Cable retention

- pull off **136** N mini
- torque **NA** N.cm

MECHANICAL CHARACTERISTICS

Center contact retention	
Axial force – Mating end	10 N mini
Axial force – Opposite end	10 N mini
Torque	NA N.cm mini

TOOLING

Part Number	Description	Hexagon
.	.	.
R282.235.013	CRIMPING DIES	1.73-6.48
R282.293.000	CRIMPING TOOL M22520/5-01	-
R282.223.000	CRIMPING TOOL	1.73-6.48

Recommended torque	
Mating	NA N.cm
Panel nut	NA N.cm
Clamp nut	NA N.cm
A/F clamp nut	0,0000 mm

OTHERS CHARACTERISTICS

Mating life	100 Cycles mini
Weight	0,0000 g

ENVIRONMENTAL

Operating temperature	-35/+70 ° C
Hermetic seal	NA Atm.cm3/s
Panel leakage	NA

Issue : **0808 C**

In the effort to improve our products, we reserve the right to make changes judged to be necessary.



STRAIGHT PLUG CRIMP TYPE

R142.085.480

Series : **BNC 75-COM**

CABLE 6/75 S - WITH BLACK CABLE BOOT

COMPONENTS

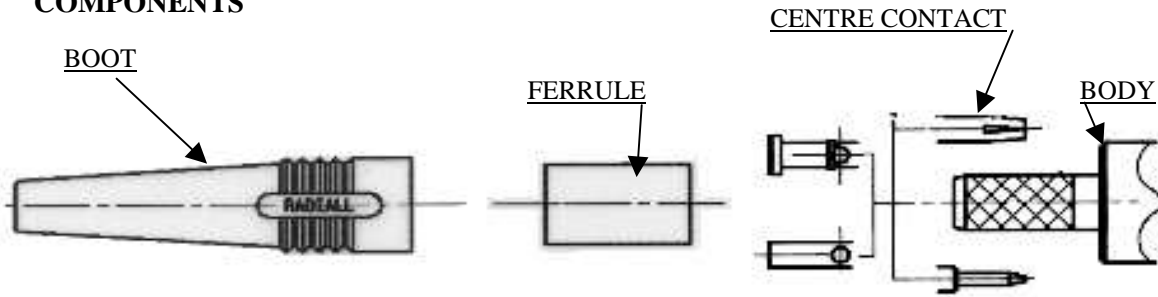

1

- Slide onto the cable the ferrule and the boot.
- Strip the cable.

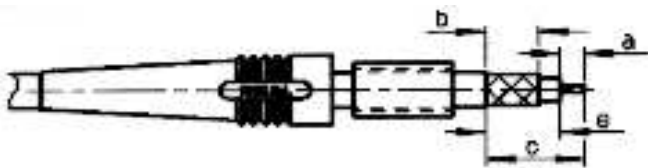

3

- Fan the braid.
- Slide cable into the body until bottoms against insulator.
- Slide ferrule over the braid.
- (In direction F)
- Crimp the ferrule with crimping tool + dies.
- Cut the excess of braid.
- Slide the boot.

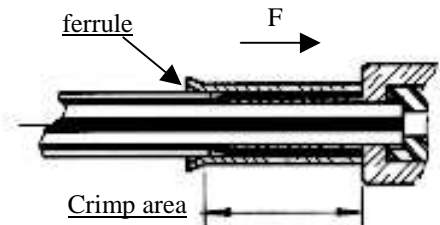

2

- Slide on centre contact until it bottoms against cable dielectric.
- Solder or crimp centre contact with crimping tool +dies .

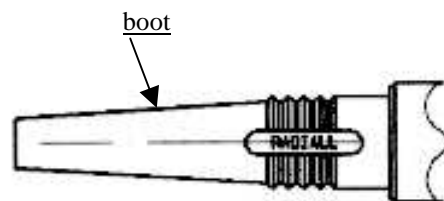
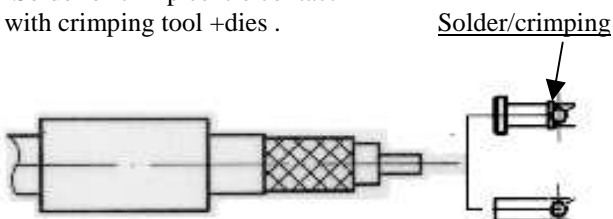

Issue : 0808 C

In the effort to improve our products, we reserve the right to make changes judged to be necessary.

